

punt

ART, CRAFT & DESIGN



STOCKHOLM

TECHNICAL INFORMATION SHEET

STOCKHOLM

BY MARIO RUIZ, 2013

punt



PRODUCT TYPE

Bedside tables, sideboards, chest drawers, cupboards & desks

The large Stockholm family, consisting of sideboards, cupboards, chests of drawers, bedside tables, tables, coffee tables, desks, lamps and rugs, is characterized by the unique use of aluminum as the material that connects all the pieces. The collection won the Red Dot Award in 2015 and has become a Punt signature icon.

TIPOLOGÍA DE PRODUCTO

Mesitas de noche, aparadores, cómodas, alacenas y escritorios

La gran familia Stockholm, compuesta por aparadores, alacenas, cómodas, mesitas de noches, mesa, mesas bajas, escritorios, lámparas y alfombras, se caracteriza por el singular uso del aluminio como hilo conductor entre todas las piezas. La colección fue merecedora del premio Red Dot en 2015 y se ha convertido en un icono de la firma Punt.

DETAILS. DETALLES



STOCKHOLM

BY MARIO RUIZ, 2013

punt

BED SIDE TABLES MESITAS DE NOCHE

STH105

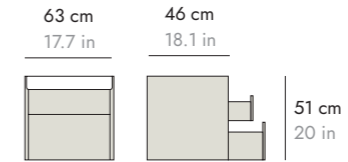
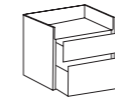

METAL BASES ZÓCALOS

	H 6 cm - 2.3"	H 17 cm - 6.7"	WALL BRACKET HERRAJE PARED
	53.5 cm 21 in 	51 cm 20 in 	

CUPBOARD 93 cm ALACENA 93 cm

STH011

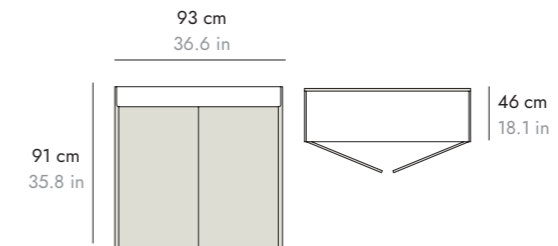
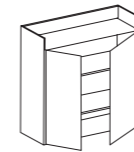

CHEST OF DRAWERS 93 cm CÓMODA 93 cm

STH012

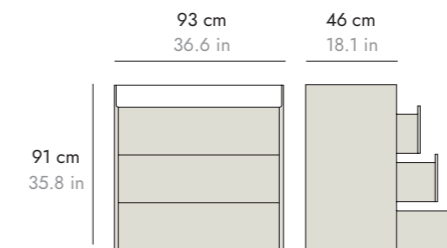
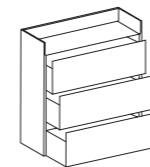

METAL BASES ZÓCALOS

	H 6 cm - 2.3"	H 17 cm - 6.7"	H 29 cm - 11.4"
	80 cm 31.4 in 	80 cm 31.4 in 	80 cm 31.4 in

STOCKHOLM

BY MARIO RUIZ, 2013

punt

SIDEBOARD 122 cm APARADORES 122 cm

STH251 Slim

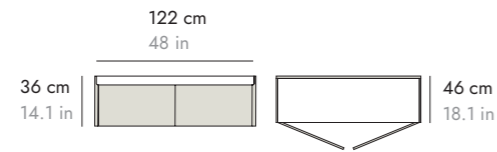
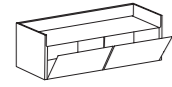

STH253 Slim + Technic doors

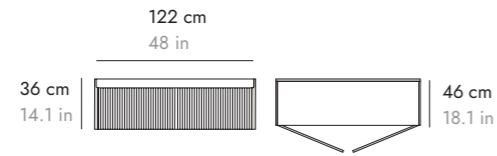
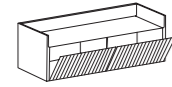

STH201

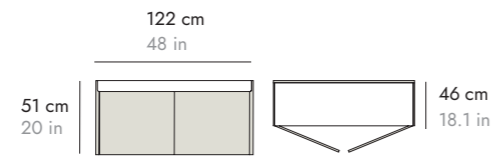
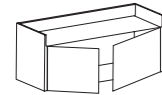

STH203 Technic doors

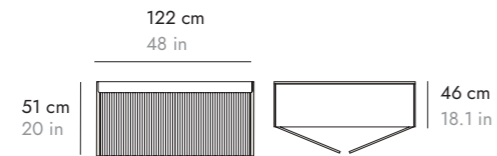
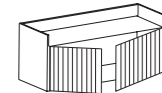

CUPBOARD 122 cm ALACENAS 122 cm

STH224 2 units metal base. Zócalo 2 módulos.

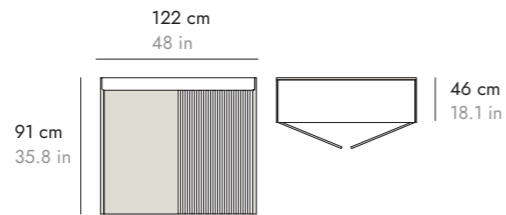
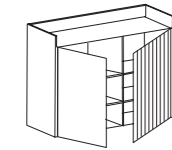

STH225 Depth for integrated fridge. Profundidad para nevera integrada.

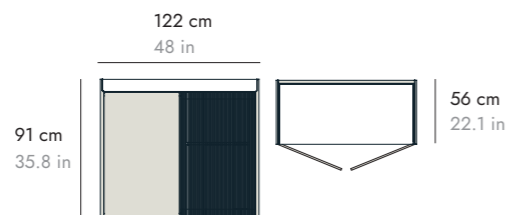
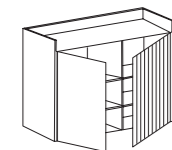

REFERENCE WITH GROMMETS
REFERENCIA CON PASACABLES

STOCKHOLM

BY MARIO RUIZ, 2013

punt

METAL BASES ZÓCALOS

	H 6 cm - 2.3"	H 17 cm - 6.7"	H 29 cm - 11.4"	WALL BRACKET HERRAJE PARED
	110 cm 43.3 in	110 cm 43.3 in	110 cm 43.3 in	

SIDEBOARD 180 cm APARADOR 180 cm

STH351 Slim

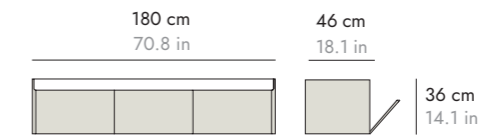
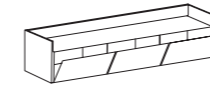

STH353 Slim + Technic doors

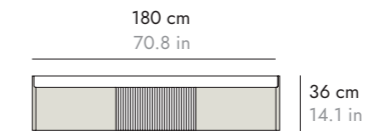
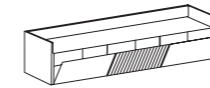

STH354 Slim + Technic doors

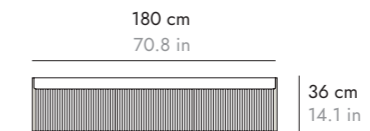
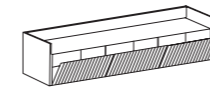

STH301

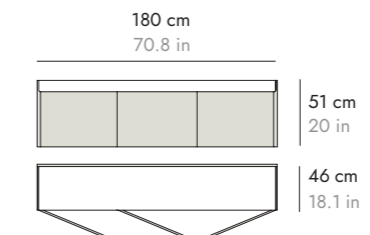
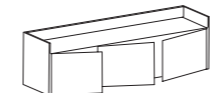

STH302

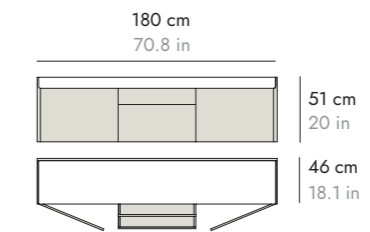
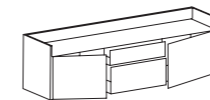

STH303 Technic doors

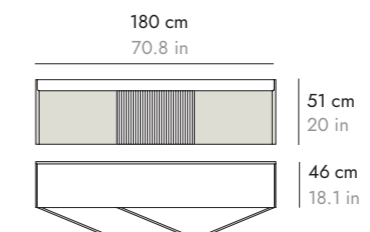
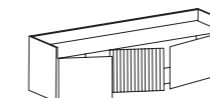

STOCKHOLM

BY MARIO RUIZ, 2013

punt

SIDEBOARD 180 cm APARADOR 180 cm

STH304 Technic doors

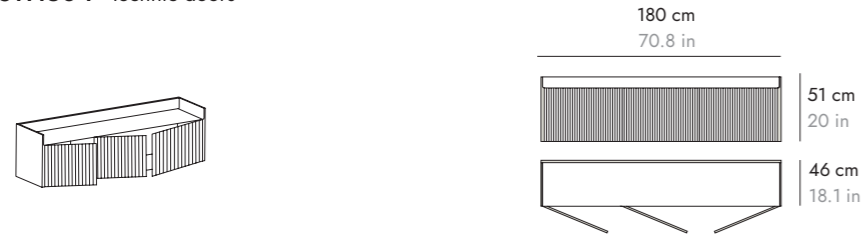

CUPBOARD 180 cm ALACENA 180 cm

STH334 Technic doors

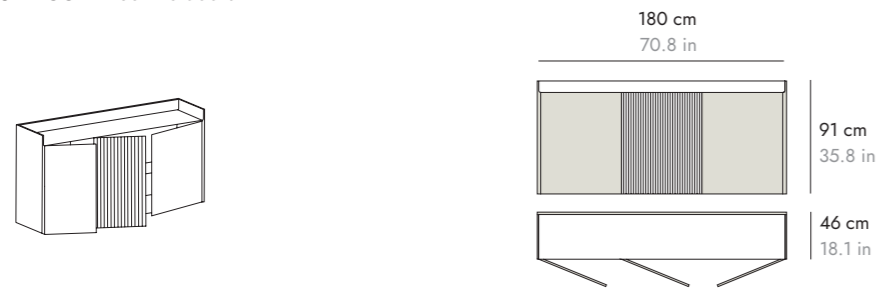

METAL BASES ZÓCALOS

	H 6 cm - 2.3"	H 17 cm - 6.7"	H 29 cm - 11.4"	WALL BRACKET HERRAJE PARED
	167 cm 65.7 in	167 cm 65.7 in	167 cm 65.7 in	

SIDEBOARD 238 cm APARADOR 238 cm

STH451 Slim



STH453 Slim + Technic doors



STOCKHOLM

BY MARIO RUIZ, 2013

punt

SIDEBOARD 238 cm APARADOR 238 cm

STH454 Slim + Technic doors



STH401



STH402



STH403 Technic doors



STH404 Technic doors



CUPBOARD 238 cm ALACENA 238 cm

STH434 Technic doors

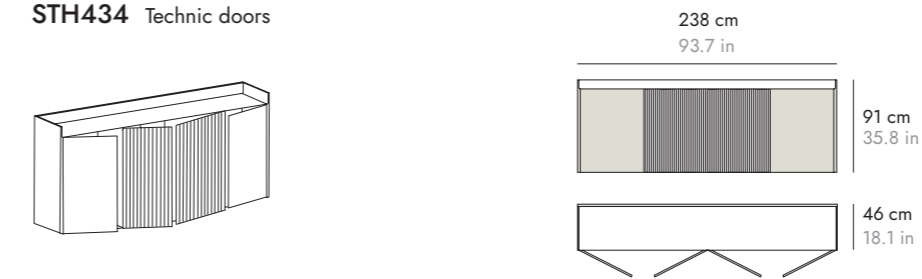





STOCKHOLM

BY MARIO RUIZ, 2013

punt

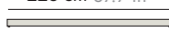
METAL BASES ZÓCALOS

	H 6 cm - 2.3"	H 17 cm - 6.7"	H 29 cm - 11.4"	WALL BRACKET HERRAJE PARED 
	223 cm 87.7 in 	225 cm 88.5 in 	225 cm 88.5 in 	

SIDEBOARD 296 cm APARADOR 296 cm

STH553 Slim

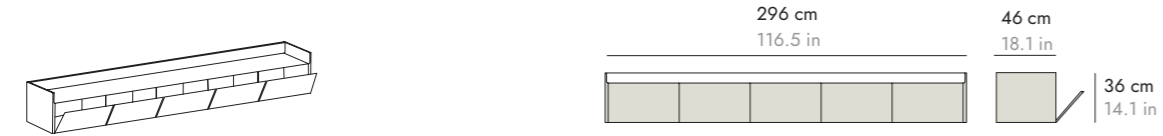

STH556 Slim + Technic doors



STH557 Slim + Technic doors



STH503

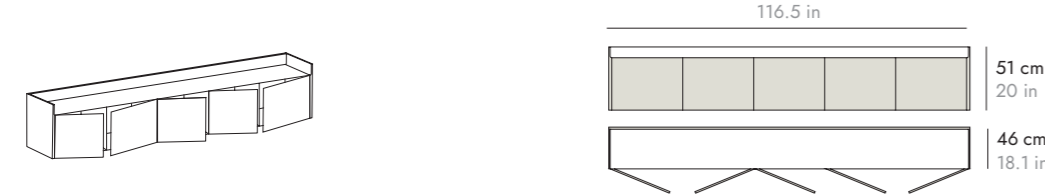

STH504 Technic doors

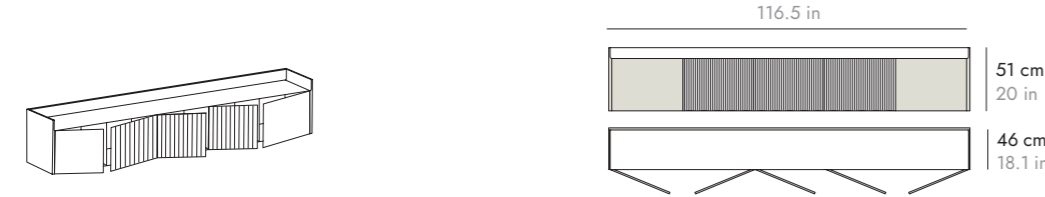

STOCKHOLM

BY MARIO RUIZ, 2013



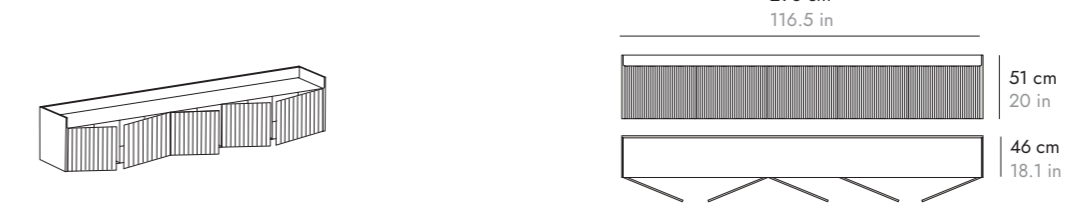

punt

SIDEBOARD 296 cm APARADOR 296 cm

STH507 Technic doors

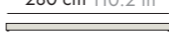

METAL BASES ZÓCALOS

	H 6 cm - 2.3"	H 17 cm - 6.7"	H 29 cm - 11.4"	WALL BRACKET HERRAJE PARED 
	280 cm 110.2 in 	283 cm 111.4 in 	283 cm 111.4 in 	

STOCKHOLM

BY MARIO RUIZ, 2013

punt

CABLE MANAGEMENT PASACABLES

The Stockholm collection offers the possibility to order the sideboards without cable grommets or with cable grommets. Those with cable grommets will have a hinged cover for cable entry in the aluminium top and one cable grommet hole per door on the back. They also include a cover cap per hole.

La colección Stockholm ofrece la posibilidad de solicitar los aparadores sin pasacables o con pasacables. Aquellos con pasacables tendrán una tapa con bisagras para el paso de cables en el sobre de aluminio y en la trasera un agujero pasacables por puerta. Incluyen también un tapón embellecedor por agujero.



Outside detail. Detalle exterior

Hinged flap on the aluminium top.
Tapa con bisagras en el sobre de aluminio.

Internal detail. Detalle interior

Cable grommets per door in top and back.
Agujeros pasacables por puerta en tapa y trasera.

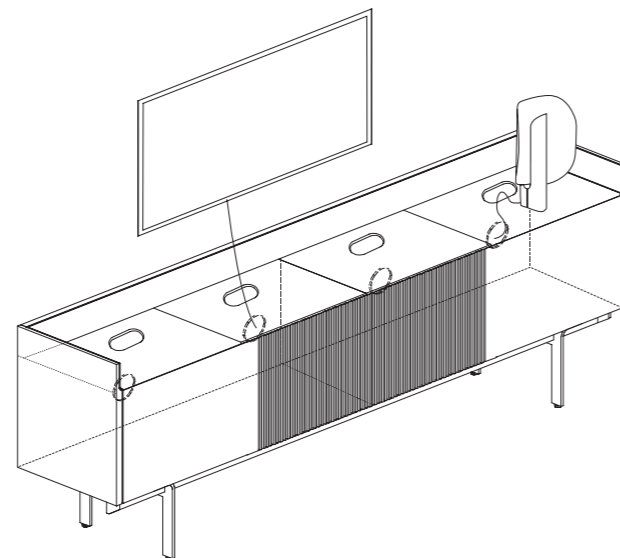
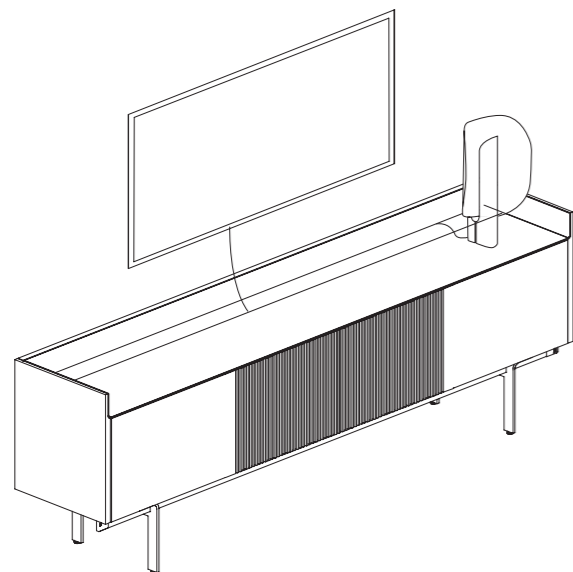

STOCKHOLM

BY MARIO RUIZ, 2013

punt

TECHNICAL SPECIFICATIONS ESPECIFICACIONES TÉCNICAS

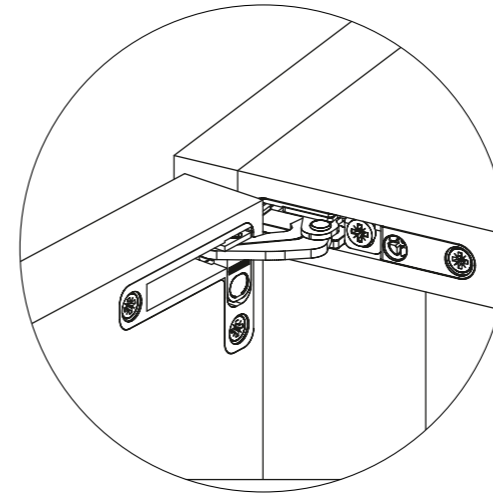

Invisible hinge fitting for side opening.
Herraje de bisagra invisible para apertura lateral.

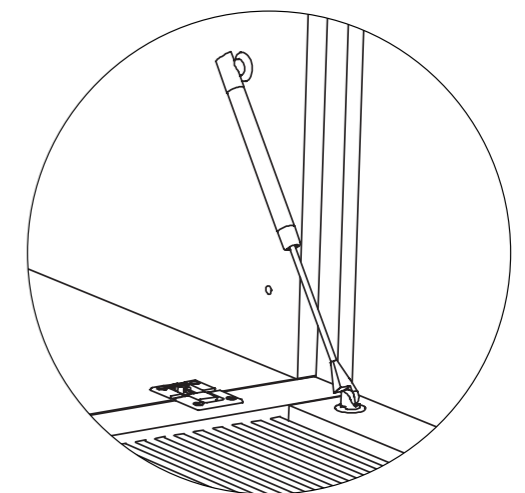

Downward opening system for SLIM sideboards.
Sistema de apertura descendente para aparadores SLIM.

- Handleless doors with 105° opening.
- Puertas sin tiradores con apertura a 105°.

- Drawers with full-extension runners.
- Cajones con guías de extracción total.

- Units with doors include height adjustable shelf.
- Los módulos con puertas incluyen estante regulable en altura.

ACCESSORIES STOCKHOLM COLLECTION ACCESORIOS COLECCIÓN STOCKHOLM

ACC027

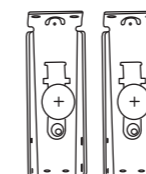

Fittings for hanging the modules on the wall.
Please consult the number of units required for each composition.

Herrajes para fijar los módulos a pared.
Consultar número de unidades necesarias para cada composición.

MATERIALS

Wood.

Interior and exterior modules in E1 MDF board and E1 particle board (low formaldehyde content) clad in oak or natural walnut with continuous mesh. Technic finish doors are solid wood slatted doors.

Aluminum.

Top in anodized aluminum or smooth matte metal.

Steel.

Textured thermo-lacquered steel plinths with adjustable feet.

MATERIALES

Madera.

Módulos interior y exterior en tablero de MDF E1 y tablero de partículas E1 (bajo contenido en formaldehído) aplacado en madera de roble o nogal natural con malla continua. Las puertas en acabado Technic son alistonadas en madera maciza.

Aluminio.

Tapa de aluminio anodizado o metal liso mate.

Acero.

Zócalos de acero termo-lacado texturizado con pies regulables.

Wooden parts Partes en madera



SUPER MATT OAK
ROBLE SÚPER MATE
CHÊNE SUPERMATE
EICHE SUPERMATT
ROVERE OPACO

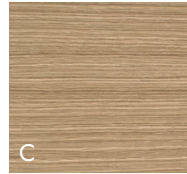

WHITENED OAK
ROBLE BLANQUEADO
CHÊNE BLANCHI
EICHE WEISS
ROVERE SBIANCATO



WALNUT STAINED OAK
ROBLE TEÑIDO NOGAL
CHÊNE TEINTÉ NOYER
EICHE NUSSBAUM
GEBEIZT
ROVERE TINTO NOLE

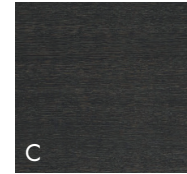

DARK GREY STAINED OAK
ROBLE TEÑIDO GRIS
CHÊNE TEINTÉ GRIS
EICHE DUNKELGRAU
GEBEIZT
ROVERE TINTO GRIGIO
SCURO

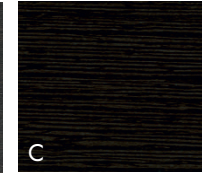

EBONY STAINED OAK
ROBLE TEÑIDO ÉBANO
CHÊNE TEINTÉ ÉBÈNE
EICHE EBENHOLZ
GEBEIZT
ROVERE TINTO ÈBANO



SUPER MATT WALNUT
NOGAL SÚPER MATE
NOYER SUPER MATE
WALNUSS SUPERMATT
NOCE OPACO



WALNUT STAINED WALNUT
NOGAL TEÑIDO NOGAL
NOYER TEINTÉ NOYER
WALNUSS WALNUSS
GEBEIZT
NOCE TINTO NOCE

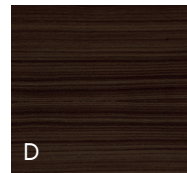

DARK STAINED WALNUT
NOGAL TEÑIDO OSCURO
NOYER TEINTÉ FONCÉ
WALNUSS DUNKEL
GEBEIZT
NOCE TINTO SCURO

Aluminium top Sobre de aluminio

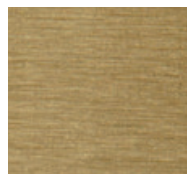

GOLD
ORO
OR
GOLD
ORO

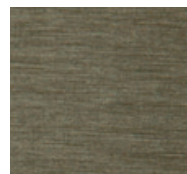

BRONZE
BRONCE
BRONZE
BRONZE
BRONZO



CHOCOLATE
CHOCOLATE
CHOCOLAT
SCHOKOLADE
CIOCCOLATO



BLACK
NEGRO
NOIR
SCHWARZ
NERO

Metal base Zócalo

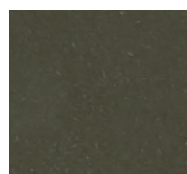

BRONZE
BRONCE
BRONZE
BRONZE
BRONZO

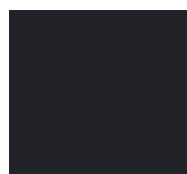

BLACK
NEGRO
NOIR
SCHWARZ
NERO